

DIRECT CONNECT SENSORS



Available gases include

- LEL, H2S, CO, & CO2
- Toxic sensors include NH3, AsH3, Cl2, ClO2, HCN, & SO2

Infrared sensor for combustibles and CO2

Patented water repellent sensor coating

Explosion proof construction

Optional stainless steel junction box

Explosion Proof IR LEL & CO2

The RKI Direct Connect series gas sensors are highly reliable and very cost effective for the detection of common gas hazards. The direct connect series are available for LEL, H2 Specific LEL, LEL IR, Oxygen, H2S, CO, CO2, and for a variety of toxic gases. The sensors for LEL, H2, Oxygen, H2S, CO2, and Carbon Monoxide are explosion-proof with flame arrestors, and approved for use in hazardous areas (Class I, Div. 1 Groups B, C, D). An optional non-explosion proof version is available for oxygen, H2S, CO, and CO2 for use in non-hazardous atmospheres.

The Direct Connect sensors can be used in two different ways. The sensors can be mounted directly to the controllers as a complete stand alone system, or they can be mounted to explosion proof junction boxes for remote detection.

The toxic sensors are electrochemical type plug-in sensors, which provide high specificity, fast response, and long life. The plug-in design allows quick replacement in the field with no tools required. Toxic sensors are designed for use in Class I, Div. 2 hazardous locations. Sensors are available for NH3, AsH3, Cl2, ClO2, HCN, PH3, and SO2.

The Direct Connect sensors can be used either indoors or outdoors. The flame arrestors for the explosion-proof versions utilize a patented coating which make them water repellent. Also, splash guards are available for use in very wet environments. An optional stainless steel junction box is available for corrosive environments.



All of the Direct Connect sensors are designed to specifically interface with RKI Beacon 110, 200, and 410A controllers.

World Leader In Gas Detection & Sensor Technology

RKI Instruments, Inc. | 33248 Central Ave. Union City, CA 94587 | Phone (800) 754-5165 | (510) 441-5656 | Fax (510) 441-5650

www.rkiinstruments.com



Explosion Proof

	LEL	LEL	O2	H2S	CO	CH4	HC	CO2
	General Purpose	H2 Specific	Oxygen	Hydrogen Sulfide	Carbon Monoxide	Methane	Hydrocarbons	Carbon Dioxide
 Sensor With J-Box	61-1000RK	61-1001RK	65-2515RK	65-2427RK-05	65-2437RK-05	65-1003RK-CH4 65-1006RK-CH4	65-1003RK-HC	61-1004RK-02
	61-1000RK-05	61-1001RK-05						61-1004RK-03
	61-1004RK-05	61-1004RK-10						
Sensors	Catalytic		Galvanic cell	Electrochemical		Infrared		
 Sensor Only  Ceiling Mount	61-0140RK(UL) 61-0140RK-05(CSA)	LEL H2 - NC-6205-01	65-2514RK	65-2428	65-2438	61-0190RK-CH4 61-0192RK-CH4	61-0190RK-HC	61-0191RK-02 61-0191RK-03 61-0191RK-05 61-0191RK-10
Measuring Range	0-100% LEL		0-25% Vol.	0-100 ppm	0-300 ppm	0-100% LEL 0-100% Vol.	0-100% LEL	-02 0-5000ppm -03 0-5.0% Vol. -05 0-50% Vol. -10 0-100% Vol.
Lower Detectable Limit(LDL)	2% of full scale		0.1% Vol.	2% of full scale				
Respose Time (T-90)	LEL-30 Seconds	LEL H2-20 Senconds	20 Senosds	35 Seconds		30 Senconds	30 Senconds	30 Senconds
Accuracy	+/- 5% of full scale (0.5% volume for oxygen)							
Life Expectancy	2 to 3 years with normal service	3 to 5 yeas with normal service	2 to 3 years with normal service			5 years with normal service		
Operating Evironment								
Location	Indoor or ourdoor. Explosion proof for Class I, Groups B, C, and D atmospheres.							
Temperture	-40°F to 167°F 40°C to 75°C	-4°F to 113°F -20°C to 45°C	-40°F to 104°F -40°C to 75°C	23°F to 104°F -5°C to 40°C	-40°F to 122°F -40°C to 50°C			
Humidity	0 - 99% RH non condensing							
Housing								
Housing J-Box	Cast aluminum, explosion-pooof, optional stainless steel J-Box available							
Sensor	Stainless steel, explosion-pooof							
Approvals	61-1000RK	61-1001RK UL	CSA NRTL			c UL us		
	61-1000RK-05 CSA	61-1001RK-05 CSA						
Controllers	Compatible with the following controllers: Beacon 110, Beacon 200, Beacon 410							
Warranty	One year materials and workmanship							

Non Explosion Proof

	O2	H2S	CO	Toxics	CO2
	Oxygen	Hydrogen Sulfide	Carbon Monoxide		Carbon Dioxide
 Sensor With J-Box	65-2497RK *65-2502RK	65-2498RK	65-2499RK	See Chart Below	61-1007RK-02 61-1007RK-03 61-1007RK-05 61-1007RK-10
Sensors	Galvanic cell	Electrochemical			Infrared
Sensor Only	65-2494RK *65-2510RK	65-2495RK	65-2496RK	See Chart Below	61-0198RK-02 61-0198RK-03 61-0198RK-05 61-0198RK-10
Measuring Range	0-25% Vol.	0-100 ppm	0-300 ppm		0-5000ppm 0-5.0% Vol. 0-50% Vol. 0-100% Vol.
Lower Detectable Limite (LDL)	0.1% Vol.	2% of full scale			
Respose Time (T-90)	20 Seconds or less	35 Senconds or less		60 Seconds or less	30 Seconds or less
Accuracy	+/- 5% of full scale (0.5% volume for oxygen)				
Life Expectancy	2 years with normal service	2 to 3 yeas with normal service			5 years plus with normal service
Operating Evironment					
Location	Indoor or outdoor. Class I, Div. 2				
Temperture	-4°F to 122°F -20°C to 50°C		14°F to 104°F -10°C to 40°C		-40°F to 122°F -40°C to 50°C
Humidity	0-99% RH non condensing				
Housing					
Housing J-Box	Cast aluminum, explosion-pooof				
Sensor	Aluminum				
Controllers	Compatible with the following controllers: Beacon 110, Beacon 200, Beacon 410A				
Warranty	One year materials and workmanship				

* Parial pressure sensor for helium (He) applications. Consult factory for details.

		Toxic Transmitter Sensor Ordering Information				
		Part Number With J-Box	Gas	Range	Resolution	Sensor type
ESM-01	CT-7	65-2648RK-NH3	Ammonia (NH3)	0 - 75.0 ppm	0.1 ppm	EMS-01
		65-2648RK-AsH3	Arsine (ASH3)	0 - 75.0 ppm	0.1 ppm	EMS-01
		65-2670RK-CL2	Chlorine (Cl2)	0 - 3.00 ppm	0.01 ppm	CT-7
		65-2670RK-CL210	Chlorine (Cl2)	0 - 10.0 ppm	0.1 ppm	CT-7
		65-2670RK-CLO2	Chlorine Dioxide (ClO2)	0 - 1.00 ppm	0.01 ppm	CT-7
		65-2648RK-HCN	Hydrogen Cyanide (HCN)	0 - 15.0 ppm	0.1 ppm	EMS-01
		65-2648RK-RH3	Phosphine (PH3)	0 - 1.00 ppm	0.01 ppm	EMS-01
		65-2648RK-SO2	Sulfur Dioxide (SO2)	0 - 6.00 ppm	0.01 ppm	EMS-01

AVAILABLE ACCESSORIES



Remote Mount
Calibration Adaptor



Remote horns & lights



Calibration kits

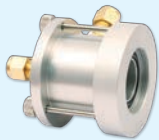

Flow through adaptors



Battery
Backup



Datalogger

Direct Interface with Beacon 110 / 200 / 410A Controllers

Direct Connect Wiring Matrix		
Sensor	Number of Wires to Controller	Maximum Distance to Controller
		18 AWG wire min.
LEL / CO ₂	4	500 ft.
Oxygen	2	500 ft.
H ₂ S	2	500 ft.
CO	2	500 ft.
Toxics	2	500 ft.

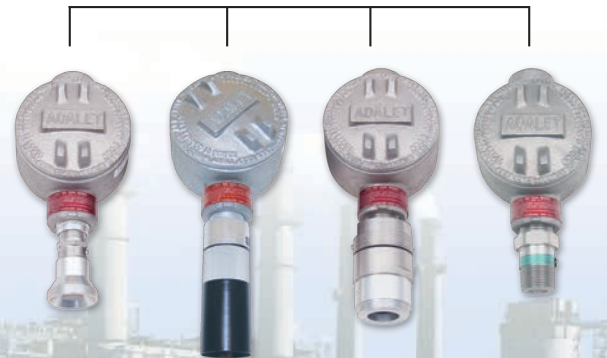

Made in the USA

Authorized Distributor: